

# extra space

without having to move



## Offices • Sleepouts • Lunchrooms • Accommodation

- ▶ Your need for extra space is our call to action. Whether you need additional short or long-term room at home or at work, or you require flexibility to accommodate an increase in staff, our range of sturdy, practical, portable buildings has an option to suit.
- ▶ All units supplied as standard are hard-wired, ready to simply plug in. All buildings comply with the New Zealand Building Standards.
- ▶ No sooner have you discussed your needs with us and made a decision, then we will be creating your new space – for work, for home, for leisure, or all three.
- ▶ Buy the building outright, hire from us, or make your mind up when you've used one for a while. The choice is yours. Whatever you decide, Portabuild takes the worry out of the equation.



**Portabuild**  
**0800 668 322**  
[www.portabuild.co.nz](http://www.portabuild.co.nz)

“The Portabuild team has consistently provided us with a very professional and timely service and has been integral to the New Zealand Fire Service maintaining its services to the Canterbury community. Their staff are a pleasure to deal with.”

Suzanne Price  
Project Manager, Construction  
New Zealand Fire Service

## Benefits



Each Portabuild relocatable building offers:

- Flexibility for any environment – on a carpark, grass, even inside a warehouse!
- A speedy solution to extra space requirements: your new building will take just two weeks from brief to installation
- Warmth in winter: our units are insulated and double-glazed
- A cost-effective option to hire or buy
- Easy customisation and configuration to suit your needs, plus adaptability later on if required
- Freedom from hefty building costs & inconvenience: we create your unit at our factory and deliver it to you fully constructed

From keeping an eye on teenagers or an elderly relative and providing

a meeting room or additional office, to providing holiday accommodation for family or for extra income, you decide – we deliver. We also provide classrooms, government or medical facilities, canteen space, ablution blocks, hobby rooms or even retail ‘pop-ups’.

### ► Standard Inclusions

- Patch panels in all units 4.8 metres & over
- Air Conditioning in all units over 6 metres
- New Zealand engineered & made for New Zealand conditions - quality assurance & New Zealand warranties
- Commercial grade floor coverings - very durable & hard wearing
- Electrical WOF - guarantees your safety (caravan plugs only)

- Portable - unlimited uses
- Modular layout - doors, windows & electrical fittings have standard locations
- 75mm EPS panel, Spouting
- Double glazing to all joinery
- Under floor insulation, Downpipes
- Carpet & carpet underlay
- Power & Data points as required
- Base flashings, NZ Steel Bases

### ► Optional Extras

- Partition walls
- Security grilles
- Kitchenette
- Gas califont
- Water boiler
- Shower, toilet, urinal
- Hand basin
- Extra windows
- Extra lights, Extra power points
- Deck

## Accommodation

Sleepouts, baches, rentals, B&B units, holiday cabins. We make to any size, but these are popular sizes.

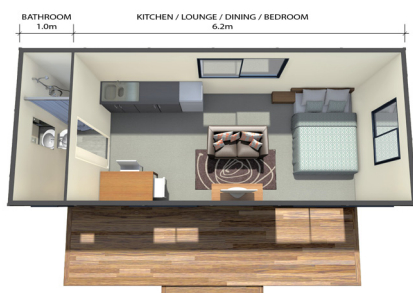

7.2 x 2.9



8.4 x 4.0

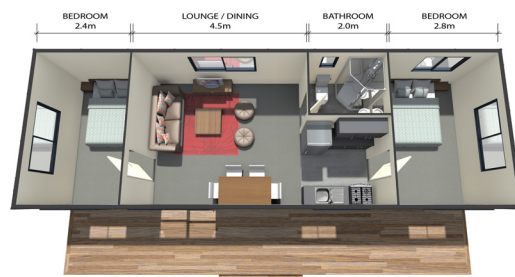

12.0 x 4.0

0800 668 322

More floorplans online [www.portabuild.co.nz](http://www.portabuild.co.nz)



“Portabuild solved our urgent need for more space. Our factory was at capacity and we needed an office urgently for our staff to work from. We found the Portabuild staff fantastic and very professional in their approach to solving our problem. The building looks great and our people find it a very good environment to work in.”

Hendrick Goller, Managing Director  
ARDEX New Zealand Ltd

## Floor Plans



### Multipurpose

Offices, ticket offices, boardrooms, classrooms, storerooms, shops, showrooms, labs, guardhouses, hobby rooms

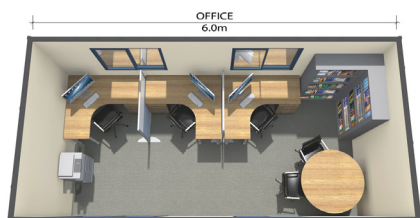

6.0 x 2.9



6.0 x 2.9

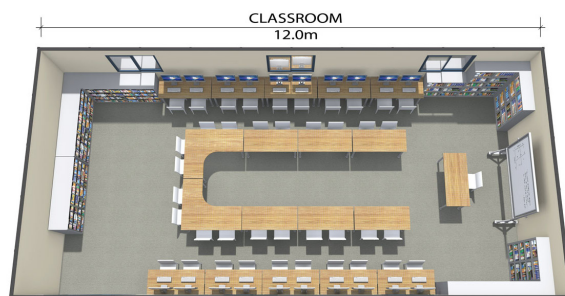

12.0 x 5.8

### Sleepouts

Events, camping grounds



3.6 x 2.4



4.8 x 2.9



6.0 x 2.9

### Ablutions

Events, construction sites, camping grounds



1.8 x 1.8



6.0 x 2.9

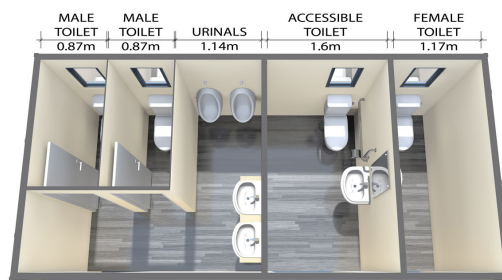

6.0 x 2.9

0800 668 322

More floorplans online [www.portabuild.co.nz](http://www.portabuild.co.nz)



Our subdivision required specific needs including the housing of a main administration hub, lunch room and ablution facilities as well as several other individual units. Portabuild provided us with design, rental and purchasing options, all in a timely and professional manner...ensuring all our needs were met."

Steve Savery  
Construction Manager  
Arrow International (NZ) Ltd



#### › Manufacturing

All our buildings are built using high-density expanded polystyrene panel, covered both sides using New Zealand Colorsteel. We're proud to use New Zealand suppliers of major components including panel, joinery, electrical and plumbing items.

#### › Hire

Our buildings are available for commercial or residential use on short or long term hire at competitive rates. Sizes and available options are based on industry standards. Please phone for a free quote.

#### › Delivery

All buildings attract a transportation cost, and they require Hiab delivery (a small crane on the back of a truck). This cost varies due to the size of the building and the time taken to deliver so please ask our sales team for a delivery quote. We may wish to visit your property to confirm our vehicle can gain access to the drop site.

#### › Sale

Choose from our building range and add items from our optional extras list. If our range does not meet your requirements, our sales team will help you design a building to suit your needs and budget.

#### › Ethics

Portabuild is one of the brands that make up the Spanbild Group, a recognised industry leader that also owns Versatile Homes and Buildings, Ideal Buildings and Totalspan. Portabuild's pedigree is well proven and aspires to the Spanbild Group's purpose of providing quality, affordable manufactured buildings, designed and built for life

#### › Colours

Our buildings are finished with Titania roof and walls and New Denim Blue joinery and flashings. Other colours are available on request.

Portabuild has you covered

**0800 668 322**

[www.portabuild.co.nz](http://www.portabuild.co.nz)

[sales@portabuild.co.nz](mailto:sales@portabuild.co.nz)

